

ST 2Jaw Scroll Chuck (Soft top Jaws)

Thru Hole Range : $\varnothing 57 \sim \varnothing 100$
Clamping Range : $\varnothing 4 \sim \varnothing 300$

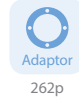

Application / Benefits

For square or rectangular requiring through hole

Technical features

Two-piece base and soft top jaws

Rear mounting only

Self-centering jaws manually opened and closed by t-handle

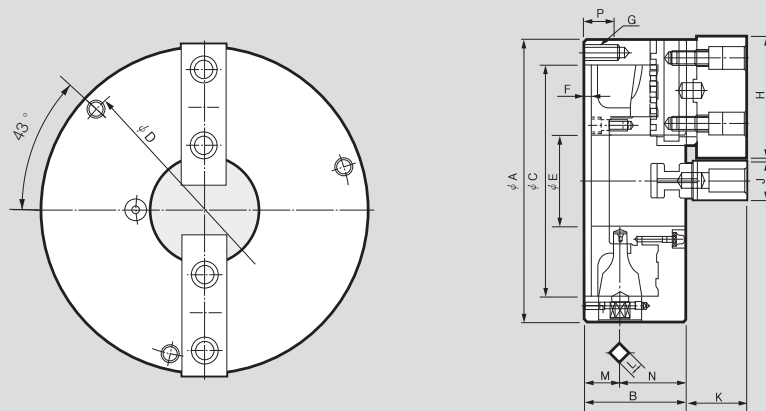

DIMENSIONS

	ST-190(7")	ST-230(9")	ST-273(10")	ST-310(12")
$\varnothing A$	192	232	273	310
B	78.7	83.7	88	96
$\varnothing C(H6)$	155	190	230	260
$\varnothing D$	172	210	250	285
$\varnothing E$	57	75	89	100
F	5	6	6	7
G	3-M10	3-M12	3-M12	3-M12
H	88	100	110	125
J	32	32	35	40
K	44.8	49.8	54.32	50.58
L	11	12	12	14
M	27.5	29.5	31.5	31.5
N	51.2	54.2	56.5	64.5
P	20	25	25	25

SPECIFICATIONS

	ST-190(7")	ST-230(9")	ST-273(10")	ST-310(12")
Max. Static Gripping Force [kN(kgf)]	20.7(2110)	24.7(2518)	46(4691)	55(5608)
Clamping Range External [ϕ mm]	4~180	5~220	5~260	10~300
Clamping Range Internal [ϕ mm]	62~170	70~210	70~250	86~290
Handle Torque [N · m(kgf · m)]	73.5(7.5)	98(10.0)	176.5(18.0)	206(21.0)
Max. r.p.m. [min^{-1}]	3500	2900	2500	2200
Weight [kg]	12.6	21.4	28	41
Moment of inertia [N · m ² (kg · m ²)]	2.55(0.26)	6.27(0.64)	9.90(1.01)	23.0(2.35)