

SMP TYPE

▶ SMP-TYPE

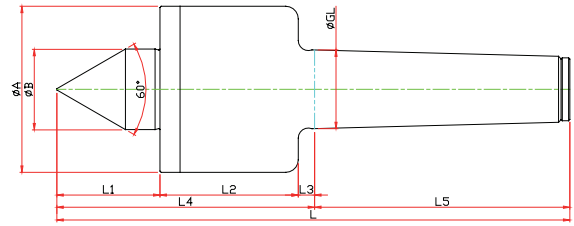

Model	Order Number	Morse Taper	Dimension										Weight MAX.	R.P.M MAX.	Run Out
			GL	A	B	L1	L2	L3	L4	L5	L				
LC-3SMP	050003	NO.3	23,825	52	22	30	51	5	86	81	167	330	12000	0.003	
LC-4SMP	050004	NO.4	31,267	66	32	41	55	6.5	102.5	101.5	204	1100	10000	0.003	
LC-5SMP	050005	NO.5	44,399	82	40	51	75	6.5	132.5	129.5	262	2200	8000	0.005	

▶ SMPB-TYPE

※ SHAFT EXTENTION(Minimize the bite-interference)

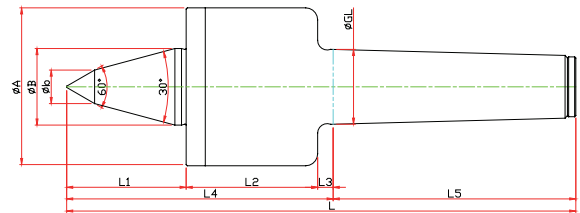

Model	Order Number	Morse Taper	Dimension										Weight MAX.	R.P.M MAX.	Run Out
			GL	A	B	b	L1	L2	L3	L4	L5	L			
LC-3SMPB	051003	NO.3	23,825	52	22	10	40	51	5	96	81	177	330	12000	0.003
LC-4SMPB	051004	NO.4	31,267	66	32	14	50	55	6.5	111.5	101.5	213	1100	10000	0.003
LC-5SMPB	051005	NO.5	44,399	82	40	16	65	75	6.5	146.5	129.5	276	2200	8000	0.005

▶ SMPC-TYPE

※ Carbide Type

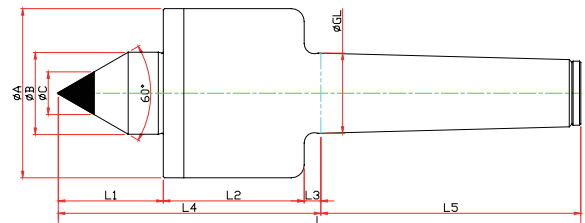

Model	Order Number	Morse Taper	Dimension										Weight MAX.	R.P.M MAX.	Run Out
			GL	A	B	L1	L2	L3	L4	L5	C	L			
LC-3SMPC	050103	NO.3	23,825	52	22	30	51	5	86	81	10	167	330	12000	0.003
LC-4SMPC	050104	NO.4	31,267	66	32	41	55	6.5	102.5	101.5	14	204	1100	10000	0.003
LC-5SMPC	050105	NO.5	44,399	82	40	51	75	6.5	132.5	129.5	18	262	2200	8000	0.005

SMP TYPE

▶ SMPBC-TYPE

- ※ SHAFT EXTENTION(Minimize the bite-interference)
- ※ Carbide Type

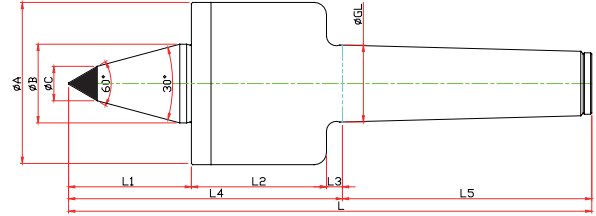

Model	Order Number	Morse Taper	Dimension											Weight MAX.	R.P.M MAX.	Run Out
			GL	A	B	b	L1	L2	L3	L4	L5	C	L			
LC-3SMPBC	051103	NO.3	23,825	52	22	10	40	51	5	96	81	10	177	330	12000	0,003
LC-4SMPBC	051104	NO.4	31,267	66	32	14	50	55	6,5	111,5	101,5	14	213	1100	10000	0,003
LC-5SMPBC	051105	NO.5	44,399	82	40	16	65	75	6,5	146,5	129,5	18	276	2200	8000	0,005

▶ SMPN-TYPE

- ※ Nut Type

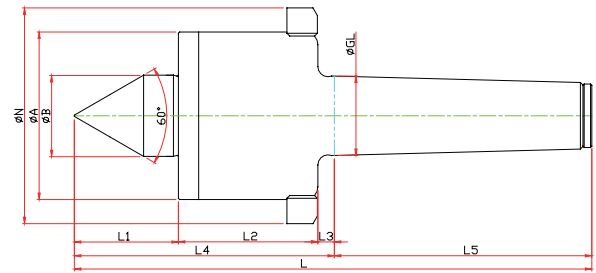

Model	Order Number	Morse Taper	Dimension											Weight MAX.	R.P.M MAX.	Run Out
			GL	A	B	L1	L2	L3	L4	L5	N	L				
LC-3SMPN	050013	NO.3	23,825	52	22	30	51	5	86	81	70	167	330	12000	0,003	
LC-4SMPN	050014	NO.4	31,267	66	32	41	55	6,5	102,5	101,5	85	204	1100	10000	0,003	
LC-5SMPN	050015	NO.5	44,399	82	40	51	75	6,5	132,5	129,5	105	262	2200	8000	0,005	

▶ SMPBN-TYPE

- ※ SHAFT EXTENTION(Minimize the bite-interference)
- ※ Nut Type

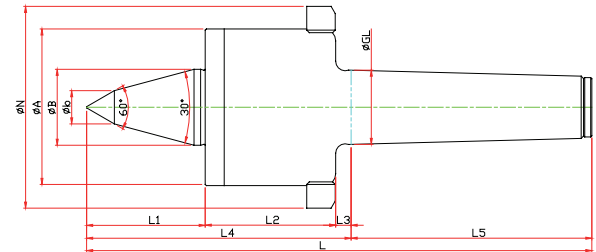

Model	Order Number	Morse Taper	Dimension											Weight MAX.	R.P.M MAX.	Run Out
			GL	A	B	b	L1	L2	L3	L4	L5	N	L			
LC-3SMPBN	051013	NO.3	23,825	52	22	10	40	51	5	96	81	70	177	330	12000	0,003
LC-4SMPBN	051014	NO.4	31,267	66	32	14	50	55	6,5	111,5	101,5	85	213	1100	10000	0,003
LC-5SMPBN	051015	NO.5	44,399	82	40	16	65	75	6,5	146,5	129,5	105	276	2200	8000	0,005

SMP TYPE

▶ SMPCN-TYPE

※ Carbide, Nut Type

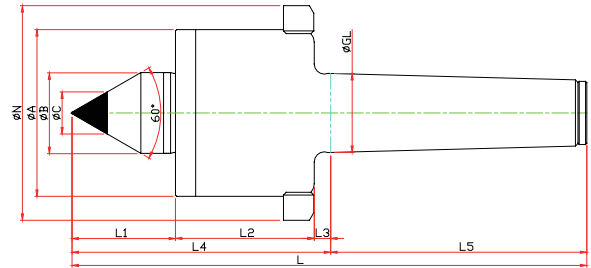

Model	Order Number	Morse Taper	Dimension											Weight MAX.	R.P.M MAX.	Run Out
			GL	A	B	L1	L2	L3	L4	L5	C	N	L			
LC-3SMPCN	050113	NO.3	23.825	52	22	30	51	5	86	81	10	70	167	330	12000	0,003
LC-4SMPCN	050114	NO.4	31.267	66	32	41	55	6,5	102,5	101,5	14	85	204	1100	10000	0,003
LC-5SMPCN	050115	NO.5	44.399	82	40	51	75	6,5	132,5	129,5	18	105	262	2200	8000	0,005

▶ SMPBCN-TYPE

※ SHAFT EXTENTION(Minimize the bite-interference)
 ※ Carbide, Nut Type

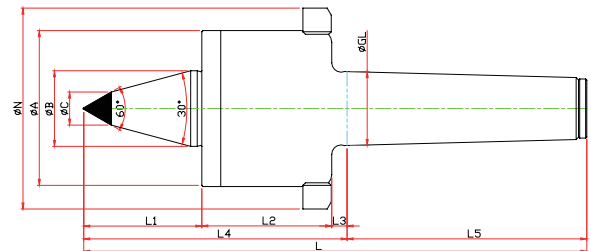

Model	Order Number	Morse Taper	Dimension											Weight MAX.	R.P.M MAX.	Run Out	
			GL	A	B	b	L1	L2	L3	L4	L5	C	N				L
LC-3SMPBCN	051113	NO.3	23.825	52	22	10	40	51	5	96	81	10	70	177	330	12000	0,003
LC-4SMPBCN	051114	NO.4	31.267	66	32	14	50	55	6,5	111,5	101,5	14	85	213	1100	10000	0,003
LC-5SMPBCN	051115	NO.5	44.399	82	40	16	65	75	6,5	146,5	129,5	16	105	276	2200	8000	0,005

▶ SMP SPECIAL

※ Customized-special production for user's condition

