

▶ NC-TYPE

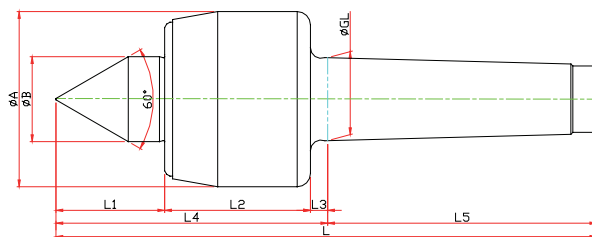

Model	Order Number	Morse Taper	Dimension										Weight MAX.	R.P.M MAX.	Run Out
			GL	A	B	L1	L2	L3	L4	L5	L				
LC-3NC	010003	NO.3	23.825	50	22	27	45	5	77	81	158	630	4800	0.003	
LC-4NC	010004	NO.4	31.267	66	32	41	55	6.5	102.5	101.5	204	1100	3800	0.003	
LC-5NC	010005	NO.5	44.399	82	40	50	65	6.5	121.5	129.5	251	1600	3400	0.005	
LC-6NC	010006	NO.6	63.384	105	45	54	80	8	142	182	324	2100	3000	0.005	

▶ NCB-TYPE

※ SHAFT EXTENTION(Minimize the bite-interference)

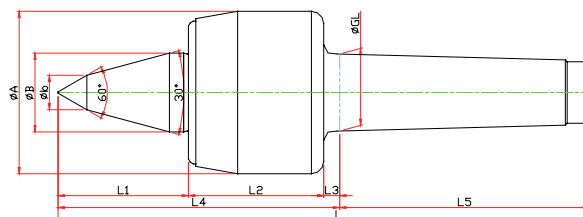

Model	Order Number	Morse Taper	Dimension											Weight MAX.	R.P.M MAX.	Run Out
			GL	A	B	b	L1	L2	L3	L4	L5	L				
LC-3NCB	011003	NO.3	23.825	50	22	10	47	45	5	97	81	178	630	4800	0.003	
LC-4NCB	011004	NO.4	31.267	66	32	14	53	55	6.5	114.5	101.5	216	1100	3800	0.003	
LC-5NCB	011005	NO.5	44.399	82	40	16	65	65	6.5	129.5	129.5	266	1600	3400	0.005	
LC-6NCB	011006	NO.6	63.384	105	45	18	78	80	8	182	182	348	2100	3000	0.005	

▶ NCC-TYPE

※ Carbide Type

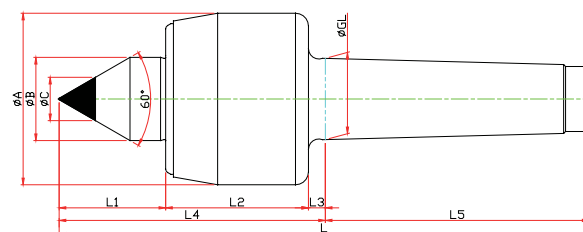

Model	Order Number	Morse Taper	Dimension										Weight MAX.	R.P.M MAX.	Run Out
			GL	A	B	L1	L2	L3	L4	L5	C	L			
LC-3NCC	010103	NO.3	23.825	50	22	27	45	5	77	81	10	158	630	4800	0.003
LC-4NCC	010104	NO.4	31.267	66	32	41	55	6.5	102.5	101.5	14	204	1100	3800	0.003
LC-5NCC	010105	NO.5	44.399	82	40	50	65	6.5	121.5	129.5	18	251	1600	3400	0.005
LC-6NCC	010106	NO.6	63.384	105	45	54	80	8	142	182	25	324	2100	3000	0.005

▶ NCBC-TYPE

- ※ SHAFT EXTENTION(Minimize the bite-interference)
- ※ Carbide Type

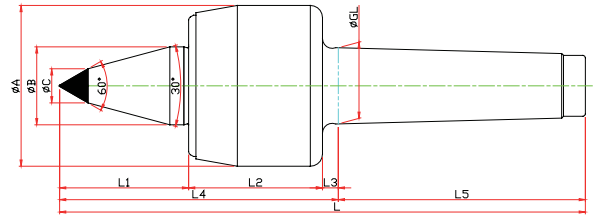

Model	Order Number	Morse Taper	Dimension										Weight MAX.	R.P.M MAX.	Run Out
			GL	A	B	L1	L2	L3	L4	L5	C	L			
LC-3NCBC	011102	NO.3	23,825	50	22	47	45	5	97	81	10	178	630	4800	0.003
LC-4NCBC	011103	NO.4	31,267	66	32	53	55	6.5	114,5	101,5	14	216	1100	3800	0.003
LC-5NCBC	011104	NO.5	44,399	82	40	65	65	6.5	136,5	129,5	16	266	1600	3400	0.005
LC-6NCBC	011105	NO.6	63,384	105	45	78	80	8	166	182	18	348	2100	3000	0.005

▶ NCN-TYPE

- ※ Nut Type

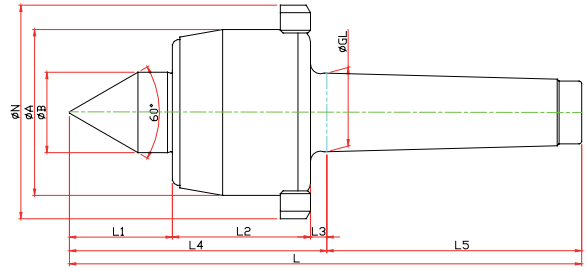

Model	Order Number	Morse Taper	Dimension										Weight MAX.	R.P.M MAX.	Run Out
			GL	A	B	L1	L2	L3	L4	L5	N	L			
LC-3NCN	010013	NO.3	23,825	50	22	27	45	5	77	81	70	158	630	4800	0.003
LC-4NCN	010014	NO.4	31,267	66	32	41	55	6.5	102,5	101,5	85	204	1100	3800	0.003
LC-5NCN	010015	NO.5	44,399	82	40	50	65	6.5	121,5	129,5	105	251	1600	3400	0.005
LC-6NCN	010016	NO.6	63,384	105	45	54	80	8	142	182	130	324	2100	3000	0.005

▶ NCBN-TYPE

- ※ SHAFT EXTENTION(Minimize the bite-interference)
- ※ Nut Type

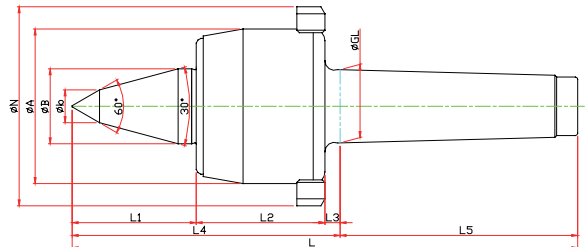

Model	Order Number	Morse Taper	Dimension											Weight MAX.	R.P.M MAX.	Run Out
			GL	A	B	b	L1	L2	L3	L4	L5	N	L			
LC-3NCBN	011013	NO.3	23,825	50	22	10	47	45	5	97	81	70	178	630	4800	0.003
LC-4NCBN	011014	NO.4	31,267	66	32	14	53	55	6.5	114,5	101,5	85	216	1100	3800	0.003
LC-5NCBN	011015	NO.5	44,399	82	40	16	65	65	6.5	136,5	129,5	105	266	1600	3400	0.005
LC-6NCBN	011016	NO.6	63,384	105	45	18	78	80	8	166	182	130	348	2100	3000	0.005

► NCCN-TYPE

※ Nut, Carbide Type Type

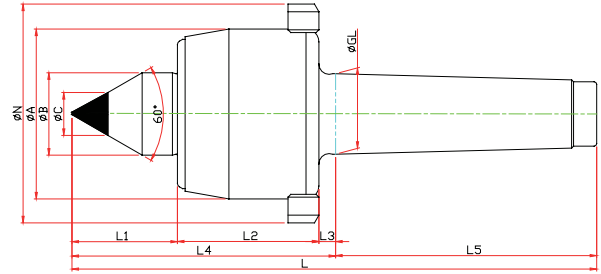

Model	Order Number	Morse Taper	Dimension											Weight MAX.	R.P.M MAX.	Run Out
			GL	A	B	L1	L2	L3	L4	L5	C	N	L			
LC-3NCCN	010113	NO.3	23.825	50	22	27	45	5	77	81	10	70	158	630	4800	0.003
LC-4NCCN	010114	NO.4	31.267	66	32	41	55	6.5	102.5	101.5	14	85	204	1100	3800	0.003
LC-5NCCN	010115	NO.5	44.399	82	40	50	65	6.5	121.5	129.5	18	105	251	1600	3400	0.005
LC-6NCCN	010116	NO.6	63.384	105	45	54	80	8	142	182	25	130	324	2100	3000	0.005

► NCBCN-TYPE

※ SHAFT EXTENTION(Minimize the bite-interference)

※ Nut, Carbide Type Type

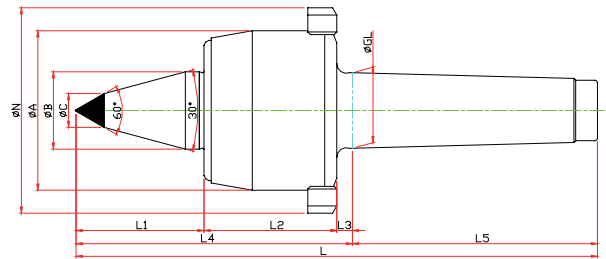

Model	Order Number	Morse Taper	Dimension											Weight MAX.	R.P.M MAX.	Run Out
			GL	A	B	L1	L2	L3	L4	L5	C	N	L			
LC-3NCBCN	011113	NO.3	23.825	50	22	47	45	5	97	81	10	70	178	630	4800	0.003
LC-4NCBCN	011114	NO.4	31.267	66	32	53	55	6.5	114.5	101.5	14	85	216	1100	3800	0.003
LC-5NCBCN	011115	NO.5	44.399	82	40	65	65	6.5	136.5	129.5	16	105	266	1600	3400	0.005
LC-6NCBCN	011116	NO.6	63.384	105	45	78	80	8	166	182	18	130	348	2100	3000	0.005

► NC-SPECIAL

