

D50 TYPE

▶ D50-TYPE

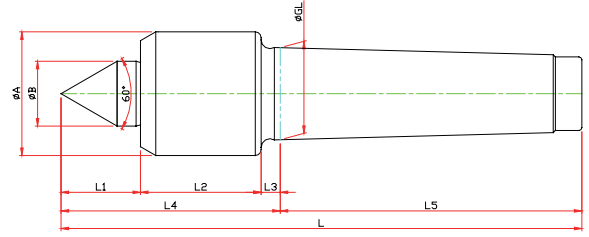

Model	Order Number	Morse Taper	Dimension										Weight MAX.	R.P.M MAX.	Run Out
			GL	A	B	L1	L2	L3	L4	L5	L				
LC-3D50	080350	NO.3	23,825	34	22	21	38	5	64	81	145	400	4800	0,003	
LC-4D50	080450	NO.4	31,267	42	22	27	41	6,5	74,5	102,5	177	800	3800	0,003	
LC-5D50	080550	NO.5	44,399	58	32	35	60	6,5	101,5	129,5	231	1600	3400	0,005	

▶ D50B-TYPE

※ SHAFT EXTENTION(Minimize the bite-interference)

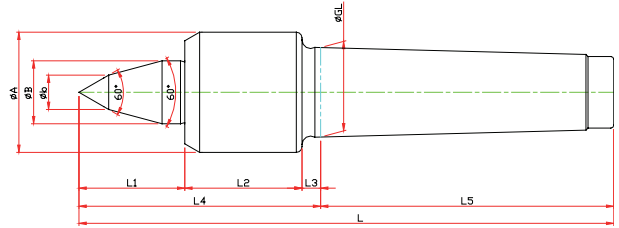

Model	Order Number	Morse Taper	Dimension										Weight MAX.	R.P.M MAX.	Run Out
			GL	A	B	b	L1	L2	L3	L4	L5	L			
LC-3D50B	082350	NO.3	23,825	34	22	10	25	38	5	72	81	153	400	4800	0,003
LC-4D50B	082450	NO.4	31,267	42	22	12	36	41	6,5	83,5	102,5	186,5	800	3800	0,003
LC-5D50B	082550	NO.5	44,399	58	32	16	53	60	6,5	119,5	129,5	249	1600	3400	0,005

▶ D50C-TYPE

※ Carbide Type

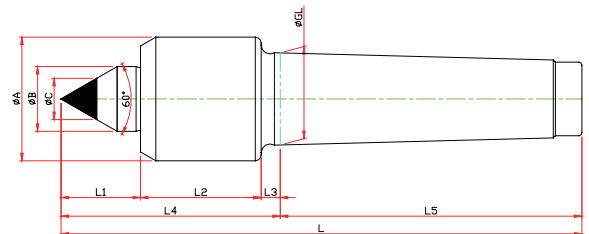

Model	Order Number	Morse Taper	Dimension										Weight MAX.	R.P.M MAX.	Run Out
			GL	A	B	L1	L2	L3	L4	L5	C	L			
LC-3D50C	081350	NO.3	23,825	34	22	21	38	5	64	81	10	145	400	4800	0,003
LC-4D50C	081450	NO.4	31,267	42	22	27	41	6,5	74,5	102,5	14	177	800	3800	0,003
LC-5D50C	081550	NO.5	44,399	58	32	60	60	6,5	101,5	129,5	18	231	1600	3400	0,005

D50 TYPE

▶ D50BC-TYPE

- ※ SHAFT EXTENSION(Minimize the bite-interference)
- ※ Carbide Type

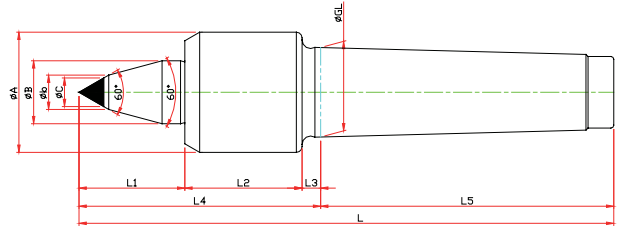

Model	Order Number	Morse Taper	Dimension											Weight MAX.	R.P.M MAX.	Run Out
			GL	A	B	b	L1	L2	L3	L4	L5	C	L			
LC-3D50BC	083350	NO.3	23,825	34	22	10	25	38	5	72	81	8	153	400	4800	0,003
LC-4D50BC	083450	NO.4	31,267	42	22	12	36	41	6,5	83,5	102,5	10	186,5	800	3800	0,003
LC-5D50BC	083550	NO.5	44,399	58	32	16	53	60	6,5	119,5	129,5	14	249	1600	3400	0,005

▶ D50 SPECIAL

- ※ Customized-special production for user's condition

