

HD TYPE

▶ HD-TYPE

※ Economical live center

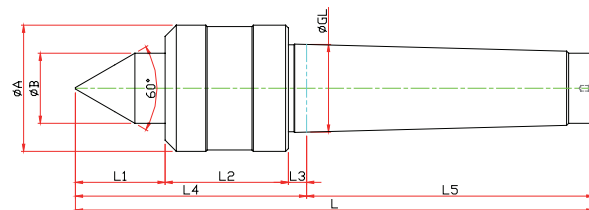

Model	Order Number	Morse Taper	Dimension									Weight MAX.	R.P.M MAX.	Run Out
			GL	A	B	L1	L2	L3	L4	L5	L			
LC-1HD	070001	NO.1	12,065	34	15	21	37	3,5	61,5	53,5	115	120	5000	0,003
LC-2HD	070002	NO.2	17,780	40	18	24	37	5	66	64	130	140	4000	0,003
LC-3HD	070003	NO.3	23,825	45	25	32	44	5	81	81	162	190	3800	0,003
LC-4HD	070004	NO.4	31,267	45	25	32	44	6,5	82,5	102,5	185	190	3800	0,003
LC-5HD	070005	NO.5	44,399	78	38	47	66	6,5	119,5	129,5	249	350	2000	0,005
LC-6HD	070006	NO.6	63,384	102	55	62	82	8	152	182	334	1200	2000	0,005

▶ HDC-TYPE

※ Carbide Type

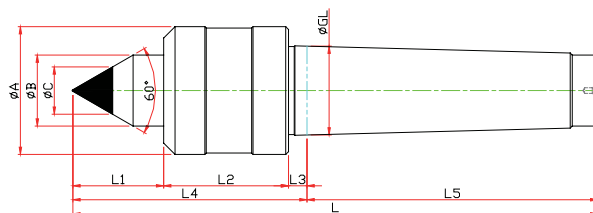

Model	Order Number	Morse Taper	Dimension										Weight MAX.	R.P.M MAX.	Run Out
			GL	A	B	L1	L2	L3	L4	L5	C	L			
LC-3HDC	071003	NO.3	23,825	25	45	32	44	5	81	81	10	162	190	3800	0,003
LC-4HDC	071004	NO.4	31,267	25	45	32	44	6,5	82,5	102,5	14	185	190	3800	0,003
LC-5HDC	071005	NO.5	44,399	38	78	47	66	6,5	119,5	129,5	18	249	350	2000	0,005
LC-6HDC	071006	NO.6	63,384	55	102	62	82	8	152	182	25	334	1200	2000	0,005

▶ HDS-TYPE

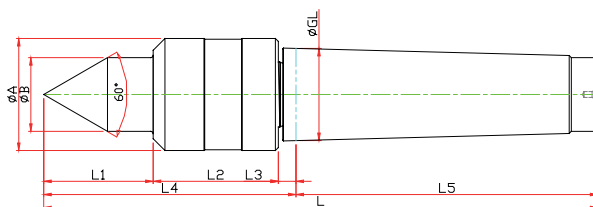

Model	Order Number	Morse Taper	Dimension									Weight MAX.	R.P.M MAX.	Run Out
			GL	A	B	L1	L2	L3	L4	L5	L			
LC-2HDS	070012	NO.2	17,780	34	15	25	40	5	70	64	134	70	4500	0,003
LC-3HDS	070013	NO.3	23,825	36	18	27,5	40,5	5	73	81	154	80	4500	0,003
LC-4HDS	070014	NO.4	31,267	38	22	32	42,5	6	80,5	102,5	183	80	4500	0,003
LC-5HDS	070015	NO.5	44,399	64	30	47	56,5	10	113,5	129,5	243	230	2000	0,005
LC-6HDS	070016	NO.6	63,384	86	42	60	66,5	10	136,5	182	318,5	600	1500	0,005

HD TYPE

▶ HDSC-TYPE

- ※ Economical live center
- ※ Suitable for lathe
- ※ Optimal RPM(below 3,800)

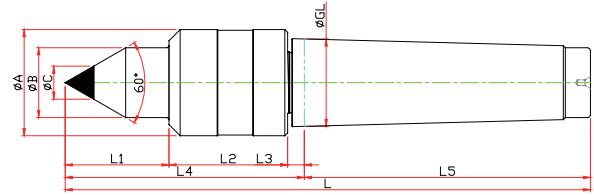

Model	Order Number	Morse Taper	Dimension										Weight MAX.	R.P.M MAX.	Run Out
			GL	A	B	L1	L2	L3	L4	L5	C	L			
LC-3HDSC	071012	NO.3	23.825	36	18	27.5	40.5	5	73	81	10	154	80	4500	0.003
LC-4HDSC	071013	NO.4	31.267	38	22	32	42.5	6	80.5	102.5	14	183	80	4500	0.003
LC-5HDSC	071014	NO.5	44.399	64	30	47	56.5	10	113.5	129.5	18	243	230	2000	0.005
LC-6HDSC	071015	NO.6	63.384	86	42	60	66.5	10	136.5	182	30	318.5	600	1500	0.005

▶ HDSTH-TYPE

- ※ The type of thread milling
- ※ triplexed bearing fit
- ※ Structure resistant to coolant
- ※ Optimal RPM(below 3,800)

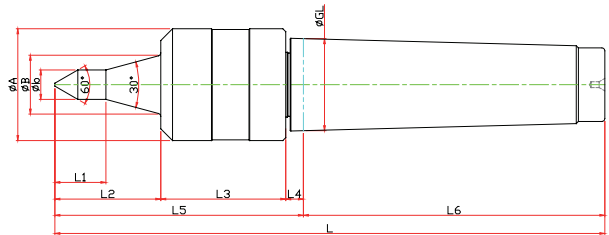

Model	Order Number	Morse Taper	Dimension											Weight MAX.	R.P.M MAX.	Run Out
			GL	A	B	b	L1	L2	L3	L4	L5	L6	L			
LC-3HDSTH-06	073011	NO.3	23.825	36	18	6	12.6	35	40.5	5	80.5	81	161.5	55	3800	0.003
LC-3HDSTH-08	073012					8	16.3									
LC-3HDSTH-10	073013					10	20.1									
LC-3HDSTH-12	073014					12	23.8									
LC-4HDSTH-06	074011	NO.4	31.267	38	20	6	10.1	36.2	40.5	6	84.5	102.5	187	65	3800	0.003
LC-4HDSTH-08	074012					8	13.9									
LC-4HDSTH-10	074013					10	17.6									
LC-4HDSTH-12	074014					12	21.3									
LC-5HDSTH-06	075011	NO.5	44.399	64	24	6	13.4	47	56.5	10	113.5	129.5	243	150	3800	0.003
LC-5HDSTH-08	075012					8	17.1									
LC-5HDSTH-10	075013					10	20.8									
LC-4HDSTH-12	075014					12	24.6									

▶ HD SPECIAL

